

How do I install my spouting?

Marley spouting and downpipes are intuitively designed as a modular system, making repair and replacement much simpler. There is a technical element to installing Marley spouting. If you are unsure, Marley recommends you seek advice from a trade professional.



Gather

Your tools and materials.

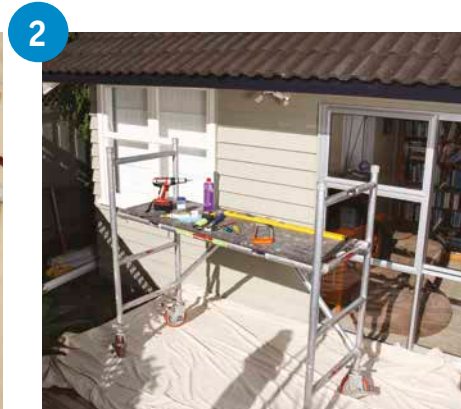

Set up

Assemble your scaffold and drop cloth around your work area and ensure appropriate safety equipment is at hand. Check the roof overhang beyond fascia is no less than 50mm.



Low points

Locate position of downpipe outlet, this will be your low point. On existing houses these are identified by existing downpipes or stormwater outlets.



String line/Chalk line

Next find your high point. Position the first bracket at determined high point as high as possible on the fascia under roof overhang. Secure string line to fascia using a screw adjacent to the first bracket and run under first bracket to the low point (see Fig 1). **Ensure a min fall of 5mm for every 10m of run.**



Brackets

Mark and secure brackets no more than 500mm apart. In high wind or snow prone areas reduce spacing to 300mm.

Use a minimum of 3 nails or 3 stainless steel screws per bracket. Minimum screw is 6g x 20mm coarse thread.

NB: Gib clouts must NOT be used.



Expansion Outlet (low point)

Position outlet at low point (in line with drain) and ensure string line aligns with feature on side tabs of outlet.

Secure outlet to fascia using a minimum of 4 fixings.

My Top Tips

- ✓ Add a Marley Curve to each downpipe to improve tank water quality or prevent drain blockages.
- ✓ Add a Marley Twist to your downpipes to capture free rainwater for watering, cleaning or emergency.
- ✓ Remember to double-check your lengths - measure twice, cut once.
- ✓ Work towards your low point (where drain is located) with a minimum fall of 5mm for every 10m.
- ✓ If you're going to paint spouting it's easier to paint on the ground before you install. See page 9 for paint recommendations.
- ✓ When replacing existing spouting, take the opportunity to check the condition of your fascia and sand/repaint as necessary.



7



Spouting

For internal brackets, position front of spouting into front of brackets, then roll spouting into back of brackets until secure.

For external brackets, position back of spouting into back of bracket, then roll spouting into front of brackets until secure.

Check every bracket is correctly engaged.

8



Expansion Allowance

Slide spouting into expansion outlet. Ensure end of spouting is aligned with the marking corresponding to the temperature at time of installation.

NB. Do not solvent weld spouting into expansion outlet.

9



Joins

Use spouting joiners and Marley MCS® solvent cement to connect lengths of spouting as necessary. For long runs over 16 metres or runs without an expansion outlet, replace one of the spouting joiners with an expansion joiner to provide further expansion allowance.

10



Corners

When required, solvent weld corners onto correct end of the spouting.

NB. Corners should be supported by brackets either side – 50mm clearance for external corners and 200mm clearance for internal corners.

11

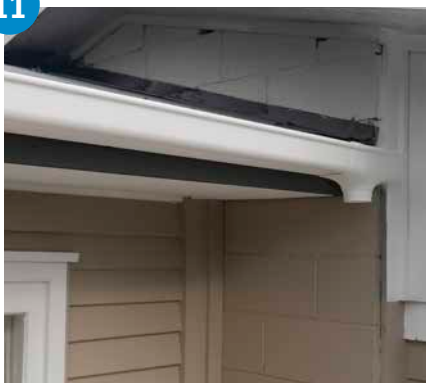

Check

Check project is safe and complete. Clean any excess Marley solvent cement (MCS®) from corners or joiners to minimise potential pooling of water. Ensure spouting is correctly secured to each bracket and space has been provided for expansion and contraction.

Note:

Marley spouting systems are not designed for use as an internal spouting system.