

## Buildashed Specifications

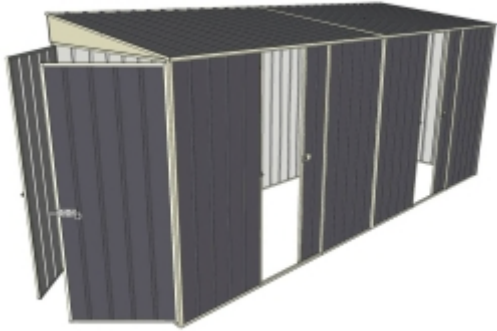

Color	Colorbond Equivalent*	Bunnings I/N
Grey	Monument	0378709
Green	Pale Eucalypt	3317435
Cream	Paperbark	3317437
Zinc	Galvanized Steel	3317438

*Equivalent color names listed are Trademarks of Bluescope Steel Limited and are only used for comparison. The use of color names indicates no more than color equivalency.*

Model	S15H245S12S15
Roof type	Skillion
Exterior dimension	1510mm x 4500mm
Interior dimension	1440mm x 4460mm
Height @ wall	1900mm
Height @ ridge	2100mm
Primary door type	Double Hinged
Primary door height	1845mm
Primary door opening	1430mm
Secondary door type	Dual Single Sliding
Secondary door height	1870mm
Secondary door opening	720 + 720mm
Area	6.80sq mt
Slab size	1635mm x 4625mm x 100mm

## Floor Plan

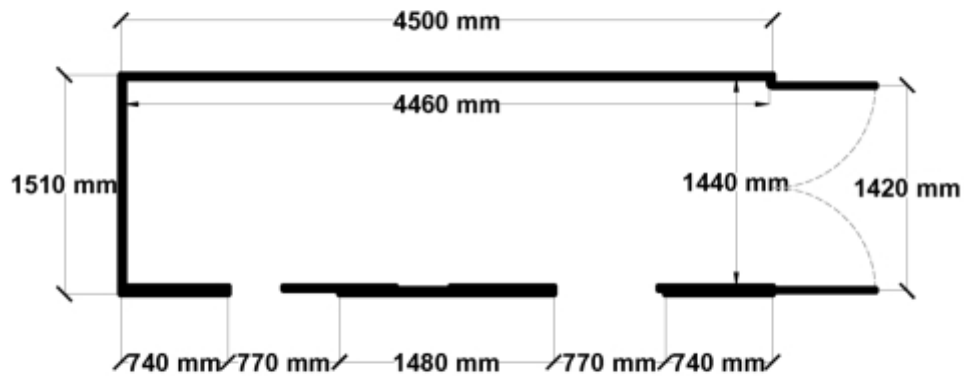

### Features

- 1.9m wall height for more head room
- All holes pre-drilled for easy assembly
- Mid-wall frame for extra strength
- Your shed will arrive in 9 boxes, with no box greater than 25kg
- Easy to follow video enhanced instructions.

Anchor brackets and masonry bolts are supplied with this shed.

Heavy duty door channel protector ramps are supplied with this shed.

*All measurements listed have a tolerance of +/- 10mm*

